

# Gîte - Self Catering Ferragudo "Casa Moinho"

Ferragudo is an idyllic fishing village with individual tourism and 4 beautiful beaches of the Barlavento in walking distance.



**Gîte - Self Catering - House**, attached home, 2 floors, separate entrance, in(on) a(an) Private property

Setting : pleasant, suitable for a relaxing break

Capacity : from 1 to 6 person(s)

Bedroom(s) : 2

Room(s) : 3



Theme breaks  
Family Vacations  
Vacations with Dog

Ferragudo - Algarve

Portugal

Advert No. 52717

www.iha.com



>> VACATION HOMES

DIRECT BY OWNERS

## Gîte - Self Catering



Gîte - Self Catering - House, attached home, 2 floors, separate entrance, in(on) a(an) Private property

- **Ideal for family, all age groups**
- **View :** panoramic, sea/ocean, garden/park, river, village, rooftop
- **Setting :** pleasant, suitable for a relaxing break
- **Exposure :** South

" Terraced house in a small village on the highest point of the old village center of Ferragudo, with a beautiful garden and terrace to the south as well as a further roof terrace. An awning and sunshades offer shade, a grill can be used for BBQ evenings on the terrace. The house is suitable for self-catering and offers WLAN, German TV and a DVD player. For the Winterabende are enough electric heaters as well as the cozy fireplace available. "

## Assets

- **Parking :**  
Parking uncovered : 1 reserved stall.



tv den

## Surroundings & location



Ocean



Golf



Fishing

" Ferragudo is located on the estuary of the Rio Arade, within 5-15 minute walk to reach the 4 beautiful bays of Felsalgarve to Ferragudo. The village offers a number of restaurants and Cafés in addition to small food shops and a market Hall, the Central village square with some Cafés is located directly below the House. "

### Leisure

- **Leisure activities less than 12 miles :**

Bathing, pedalo, snorkelling, scuba diving, Scuba diving (Standard diving dress), jet ski, surfing, windsurfing, sailing, kite surfing, canoeing, canyoning, golf, tennis, riding school, coastal/forest paths, hang-gliding, paragliding, boat trips, fishing, deep-sea fishing, fishing

### Surroundings

- **Locality :**

Sea/ocean 0.62mi.  
Sandy beach 0.3mi.  
Sea inlet 0.62mi.  
18 hole golf course 0.93mi.  
River 660'  
Marina 3mi.



living room



living room



bedroom

## Interior

- **Receive up to :**  
from 1 to 6 person(s) (4 adults, 2 kids)
- **Liveable floor area :**  
970 Sq.ft.
- **Interior layout :**  
3 Room(s), 2 bedroom(s), 2 bathroom, living room 194 Sq.ft., separate kitchen, dining area, cosy nook, tv den
- **Sleeps - bed(s) :**  
1 full bed(s), 2 twin bed(s), 1 guest folding bed(s) 1 pers, 1 baby cradle
- **Guest facilities :**  
Fireplace, T.V., hi-fi system, DVD player, cable/satelite, wifi, wardrobe, cupboard, hair dryer, electric heating, skylights, Drapes, Double glazed
- **Appliances :**  
Crockery/flatware, kitchen utensils, electric coffee maker, electric kettle, toaster, juicer, meat broiler, electric stove, mini-oven, extractor hood, refridgerator, deep freeze, washing machine, vacuum cleaner, iron, ironing board

## Exterior

- **Ground surface :**  
1,600 Sq.ft.
- **Outside accommodation :**  
Terrace 270 Sq.ft., roof terrace 300 Sq.ft.
- **Outside setting :**  
Yard 600 Sq.ft.
- **Outside amenities :**  
BBQ, yard table(s), 6 yard seat(s), parasol, 2 sun recliner(s)



kitchen

## Services

- **washing :**  
Sheets, Towels, Linen, Comforter(s), Comforter(s), Pillows
- **Single family home :**  
Cleaning on departure supplement (+\$55\*), Parking

## For your guidance

- **For your guidance**  
Kids welcome  
Pets friendly  
Cell phone network coverage  
Water : hot/cold  
Local voltage supply : 110-120V / 60Hz  
Electricity supply : mains
- **Handicapped people welcome**  
Fitted out for the disabled : mobility, visually impaired, hard of hearing, mentally



kitchen

Floor plan

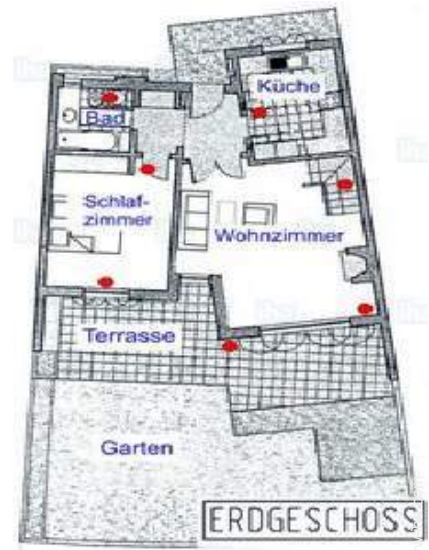
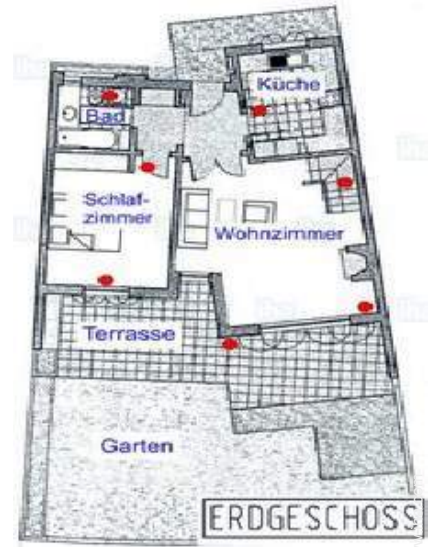
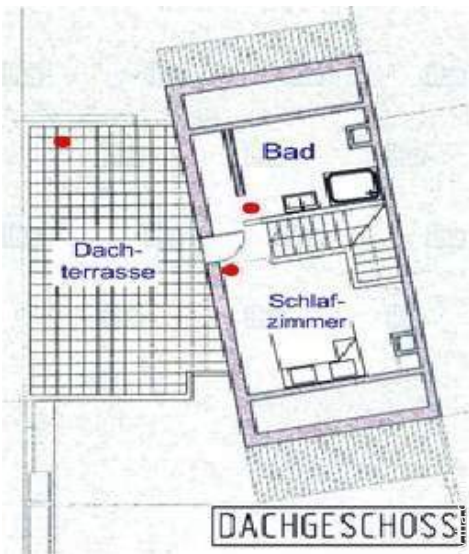

Photo album - 1



tv den



living room



living room



bedroom



kitchen

Photo album - 2



kitchen



bedroom



bathroom



bathroom



roof terrace



roof terrace



View from the property

Theme breaks

Family Vacations

Vacations with Dog

Included in the price of the accommodation

## Location



## Location & Access

" 60 km from Faro airport, next larger place: Portimão: 3 km. Sierra de Monchique: 15 km. "



GPS coordinates in degrees, minutes, seconds: Latitude 37°7'27"N - Longitude 8°31'10"W (Dwelling)

### Address

→ Rua 1º de Maio  
8400 Ferragudo

#### • Airport Faro

→ Faro, Algarve, Portugal  
→ Distance : 37,3mi.  
→ Time : 45'

#### • Railroad station Ferragudo

→ Ferragudo, Algarve, Portugal  
→ Distance : 0.93mi.  
→ Time : 5'

#### • Freeway (exit) Lagoa

→ Lagoa (Faro), Algarve, Portugal  
→ Distance : 1.85mi.

• Lagoa (Faro) : (4.5mi.)

## Contact

Spoken languages





Gîte - Self Catering  
 Ferragudo - Portugal  
**"Casa Moinho"**

Availability calendar - from : december 2020

Dec	Tu	W	Th	F	Sa	Su	M	Tu	W	Th	F	Sa	Su	M	Tu	W	Th	F	Sa	Su	M	Tu	W	Th							
2020	1	2	3	4	5	6	7	8	9	10	11	12	13	14	15	16	17	18	19	20	21	22	23	24	25	26	27	28	29	30	31
	-	-	-	-	-	-	-	-	-	-	-	-	-	-	-	-	-	-	-	-	-	-	-	-	-	-	-	-	-	-	

Jan	F	Sa	Su	M	Tu	W	Th	F	Sa	Su	M	Tu	W	Th	F	Sa	Su	M	Tu	W	Th	F	Sa	Su							
2021	1	2	3	4	5	6	7	8	9	10	11	12	13	14	15	16	17	18	19	20	21	22	23	24	25	26	27	28	29	30	31
	-	-	-	-	-	-	-	-	-	-	-	-	-	-	-	-	-	-	-	-	-	-	-	-	-	-	-	-	-	-	

Feb	M	Tu	W	Th	F	Sa	Su	M	Tu	W	Th	F	Sa	Su	M	Tu	W	Th	F	Sa	Su								
2021	1	2	3	4	5	6	7	8	9	10	11	12	13	14	15	16	17	18	19	20	21	22	23	24	25	26	27	28	
	-	-	-	-	-	-	-	-	-	-	-	-	-	-	-	-	-	-	-	-	-	-	-	-	-	-	-	-	-

Mar	M	Tu	W	Th	F	Sa	Su	M	Tu	W	Th	F	Sa	Su	M	Tu	W	Th	F	Sa	Su	M	Tu	W							
2021	1	2	3	4	5	6	7	8	9	10	11	12	13	14	15	16	17	18	19	20	21	22	23	24	25	26	27	28	29	30	31
	-	-	-	-	-	-	-	-	-	-	-	-	-	-	-	-	-	-	-	-	-	-	-	-	-	-	-	-	-	-	

Apr	Th	F	Sa	Su	M	Tu	W	Th	F	Sa	Su	M	Tu	W	Th	F	Sa	Su	M	Tu	W	Th	F							
2021	1	2	3	4	5	6	7	8	9	10	11	12	13	14	15	16	17	18	19	20	21	22	23	24	25	26	27	28	29	30
	-	-	-	-	-	-	-	-	-	-	-	-	-	-	-	-	-	-	-	-	-	-	-	-	-	-	-	-	-	-

May	Sa	Su	M	Tu	W	Th	F	Sa	Su	M	Tu	W	Th	F	Sa	Su	M	Tu	W	Th	F	Sa	Su	M							
2021	1	2	3	4	5	6	7	8	9	10	11	12	13	14	15	16	17	18	19	20	21	22	23	24	25	26	27	28	29	30	31
	-	-	-	-	-	-	-	-	-	-	-	-	-	-	-	-	-	-	-	-	-	-	-	-	-	-	-	-	-	-	

June	Tu	W	Th	F	Sa	Su	M	Tu	W	Th	F	Sa	Su	M	Tu	W	Th	F	Sa	Su	M	Tu	W							
2021	1	2	3	4	5	6	7	8	9	10	11	12	13	14	15	16	17	18	19	20	21	22	23	24	25	26	27	28	29	30
	-	-	-	-	-	-	-	-	-	-	-	-	-	-	-	-	-	-	-	-	-	-	-	-	-	-	-	-	-	-

Jul	Th	F	Sa	Su	M	Tu	W	Th	F	Sa	Su	M	Tu	W	Th	F	Sa	Su	M	Tu	W	Th	F	Sa							
2021	1	2	3	4	5	6	7	8	9	10	11	12	13	14	15	16	17	18	19	20	21	22	23	24	25	26	27	28	29	30	31
	-	-	-	-	-	-	-	-	-	-	-	-	-	-	-	-	-	-	-	-	-	-	-	-	-	-	-	-	-	-	

Aug	Su	M	Tu	W	Th	F	Sa	Su	M	Tu	W	Th	F	Sa	Su	M	Tu	W	Th	F	Sa	Su	M	Tu							
2021	1	2	3	4	5	6	7	8	9	10	11	12	13	14	15	16	17	18	19	20	21	22	23	24	25	26	27	28	29	30	31
	-	-	-	-	-	-	-	-	-	-	-	-	-	-	-	-	-	-	-	-	-	-	-	-	-	-	-	-	-	-	

Sep	W	Th	F	Sa	Su	M	Tu	W	Th	F	Sa	Su	M	Tu	W	Th	F	Sa	Su	M	Tu	W	Th							
2021	1	2	3	4	5	6	7	8	9	10	11	12	13	14	15	16	17	18	19	20	21	22	23	24	25	26	27	28	29	30
	-	-	-	-	-	-	-	-	-	-	-	-	-	-	-	-	-	-	-	-	-	-	-	-	-	-	-	-	-	-

Gîte - Self Catering  
Ferragudo - Portugal  
"Casa Moinho"

10  
[Book now](#)

Availability calendar - from : september 2021

Oct	F	Sa	Su	M	Tu	W	Th	F	Sa	Su	M	Tu	W	Th	F	Sa	Su	M	Tu	W	Th	F	Sa	Su							
2021	1	2	3	4	5	6	7	8	9	10	11	12	13	14	15	16	17	18	19	20	21	22	23	24	25	26	27	28	29	30	31
	-	-	-	-	-	-	-	-	-	-	-	-	-	-	-	-	-	-	-	-	-	-	-	-	-	-	-	-	-	-	

Nov	M	Tu	W	Th	F	Sa	Su	M	Tu	W	Th	F	Sa	Su	M	Tu	W	Th	F	Sa	Su	M	Tu							
2021	1	2	3	4	5	6	7	8	9	10	11	12	13	14	15	16	17	18	19	20	21	22	23	24	25	26	27	28	29	30
	-	-	-	-	-	-	-	-	-	-	-	-	-	-	-	-	-	-	-	-	-	-	-	-	-	-	-	-	-	

[Month : Next >>](#)

Rental rates - Gîte - Self Catering - House - from 1 to 6 Person(s)

Rates	Night	Weekend	week	2 weeks	Month
 Low season	\$83* > 7	-	-	-	-
 Mid season	\$94* > 7	-	-	-	-
 High season	\$105* > 7	-	-	-	-

> Minimum Night

[Book now](#)

Booking conditions

• Reservation

→ Payment made upon reservation :  
40% of rental sum  
→ Payment balance :  
on handing over the keys

• rentals

→ Service charges included  
→ Day tax included  
→ Cleaning charge levy on departure : \$66\*  
→ Anticipated supplement for :  
- animals  
- supplementary bed(s)

Accepted methods of payment

• Bank transfer (wire) • Cash

[▶ Book now](#)

[▶ Contact the owner](#)

Contact directly the property owners

[www.iha.com](http://www.iha.com)  
Advert No.  
52717  
[>> Book now <<](#)

Contact

Spoken languages



\* Converted at the rate indicated : €100 = \$110 = £91

Advert No. 52717

[www.iha.com](http://www.iha.com)

