

Gîte - Self Catering Paris 7th district Studio Flat

Small but fully equipped studio for budget travelers. One double bed and one single bed on the mezzanine level.



Gîte - Self Catering - Studio Flat 3rd floor, shared entrance, in(on) a(an) Restored apartment house/building 4 floors

Setting : romantic, city

Capacity : from 1 to 3 person(s)
Room(s) : 1

Paris 7th district - Paris (75) - Île de France

France

Reservation : +33 (0) 6 71 86 11 27 (France)

Advert No. 61396

www.ihacom



>> VACATION HOMES

DIRECT BY OWNERS

Gîte - Self Catering



Gîte - Self Catering - Studio Flat 3rd floor, shared entrance, in(on) a(an) Restored apartment house/building 4 floors

- **Ideal for couples, singles**
- **View :** courtyard
- **Setting :** romantic, city
- **Exposure :** North-west

" Located at the border of the 7th and the 15th arrondissement in Sevres-Lecourbe area. Great location for a Paris visit, 10 to 30 minutes away from the Louvre, the Eiffel tower, Orsay museum, Montmartre, Champs Elysées, Quartier Latin, Saint-Germain des Pres. There are 3 different metro and bus lines nearby: Sevres-Lecourbe (line 6), Volontaires (line 12) & Segur (line 10). "

Assets

- **Parking :**
Covered parking : 1 closed individual place (s).
- **baby equipment :**
High chair, infant tub, baby potty, stroller



Kitchen Area

Surroundings & location



City



Festival



Culture

" Beside being a strategic location for a Paris visit, I would also describe this area as a typical Parisian with genuine local life with many good food shops. People actually come from other arrondissement to do their shopping here. creameries/cheese shops (among Pierre Androuet's,); wine shops, bakeries/patisseries, butchers and fish shops, 6 supermarkets (Monoprix on rue Lecourbe is open until 10p.m.) Cafes, restaurants, Chocolates Jeff de Brugges too, the Pierre Hermé 5 minutes away: -) on rue Vaugirard, Le Notre at the corner, charcuterie Gilles Verot, etc.. Amenities: TV, DVDs, Radio, CD Player, Full Kitchen, Oven Stove, Refrigerator, Cooking Utensils provided. Telephone, Internet access (wifi and Cable), maps & tourist guides. Linens & towels provided, Bathroom with shower, hair dryer, iron with board, washer. There is a double bed (and a single bed for a child on the mezzanine level). This studio is slightly bigger in size than our average Parisian hotel room (+ kitchen) Windows looking onto a courtyard, located on the 2nd floor with no elevator. "

Leisure

- **Leisure activities less than 12 miles :**

Golf, tennis, squash, pony club, ten-pin bowling, pétanque field

- **Supervised :**

Tennis school, riding school

- **Attractions and relaxation :**

Bar/pub, restaurant, movie theater, park and garden, zoo/animal park, exhibition center, art gallery, historical site, museum, theater, opera house, festivals, antiques & bric-a-brac, local craftstore, cellar and wine tasting, sauna, steam baths, health spa, beauticians, fitness center

Surroundings

- **Amenities :**

Downtown <165'
Bus stop / bus station 660'
Subway station 990'
Car rental 0.3mi.
Breadstore 660'
Caterer 660'
Local stores <165'
Supermarket 660'
High class retailers 0.3mi.
Hairdressing salon 660'
Internet cafe 660'
Mail office 0.62mi.
Bank 660'
ATM 660'
Drugstore 660'
Doctor 0.3mi.

Hospital 0.62mi.
Dispensary 0.62mi.



shower room



Sleeps - bed(s)



shower room

Interior

- **Receive up to :**
from 1 to 3 person(s) (2 adults, 1 kids)
- **Liveable floor area :**
194 Sq.ft.
- **Interior layout :**
1 Room(s), 1 shower room, 1 toilets, living room 130 Sq.ft., dining area
- **Sleeps - bed(s) :**
1 full bed(s), 1 guest folding bed(s) 1 pers, 1 possible extra bed(s)
- **Guest facilities :**
T.V., DVD player, phone, internet access, high speed internet access, wifi, cupboard, radio alarmclock, hair dryer, mobile cool air fan, electric heating, skylights, digipad entry gates
- **Appliances :**
Crockery/flatware, kitchen utensils, cafetiere, electric coffee maker, electric kettle, toaster, juicer, electric stove, electric hobs, micro-wave oven, reffridgerator, deep freeze, washing machine, vacuum cleaner, iron, ironing board

Services

- **washing :**
Sheets, Towels, Comforter(s), Comforter(s), Pillows
- **Single family home :**
Parking supplement (+\$14*), Airport transfers supplement (+\$59*)

For your guidance

- **For your guidance**
Non smoking rental, cell phone network coverage
Water : hot/cold
Local voltage supply : 220-240V / 50Hz
Electricity supply : mains

Floor plan

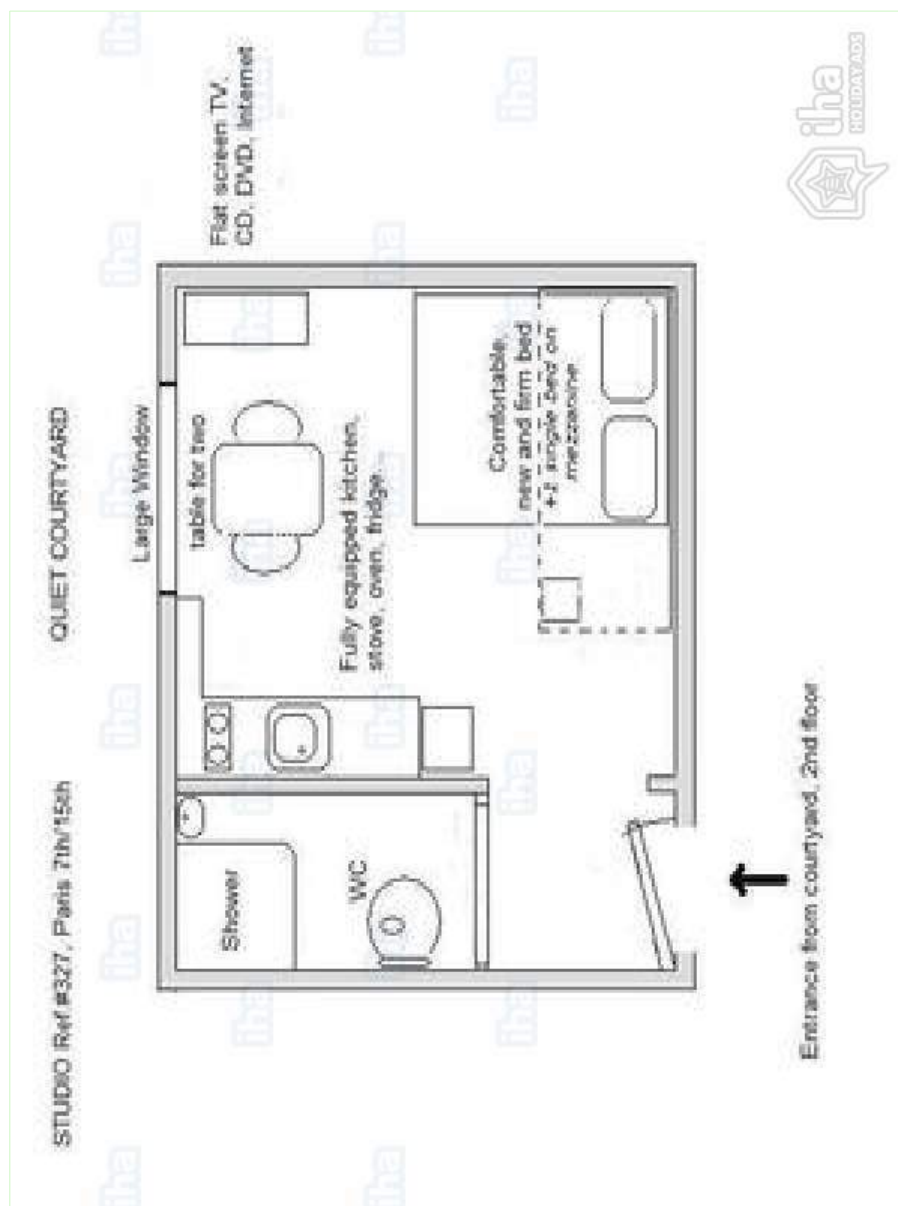

Photo album - 1



View from the property



Kitchen Area



Sleeps - bed(s)



shower room



shower room

Route map

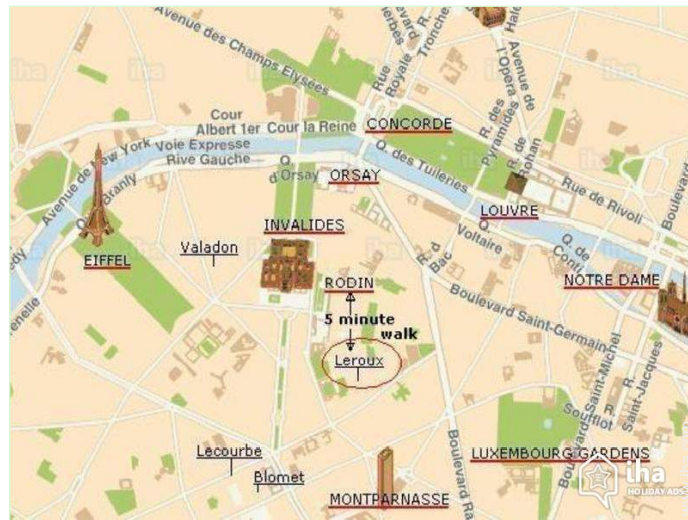
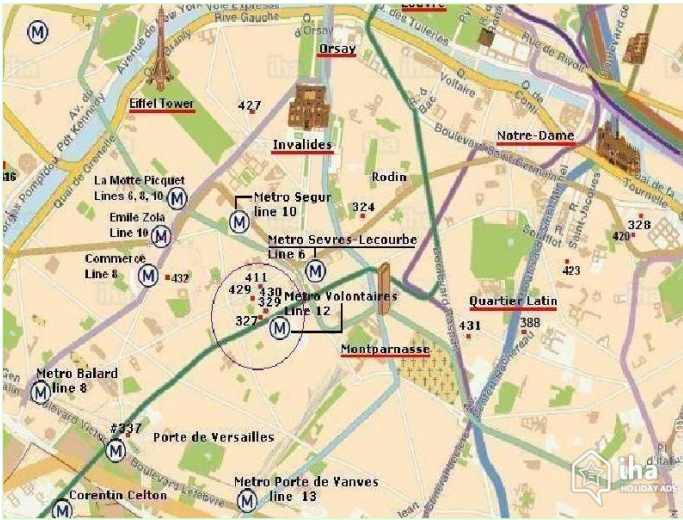

Location & Access

" Central Paris. There are 3 different metro and bus lines nearby: Sevres-Lecourbe (line 6), Volontaires (line 12) & Segur (line10). "

 GPS coordinates in degrees, minutes, seconds: Latitude 48°50'37"N - Longitude 2° 18'22"E (Dwelling)

Address

→ Vaneau
75007 Paris 7th district

→ Time : 10'

● Airport Paris Charles de Gaulle

→ Paris, Paris, Île de France, France
→ Distance : 21,7mi.
→ Time : 45'

● Airport Paris Orly

→ Paris, Paris, Île de France, France
→ Distance : 8.7mi.
→ Time : 30'

● Railroad station Paris Montparnasse

→ Paris, Paris, Île de France, France
→ Distance : 1.25mi.

● Paris 6th district : (0.93mi.)

Contact

Spoken languages



Location

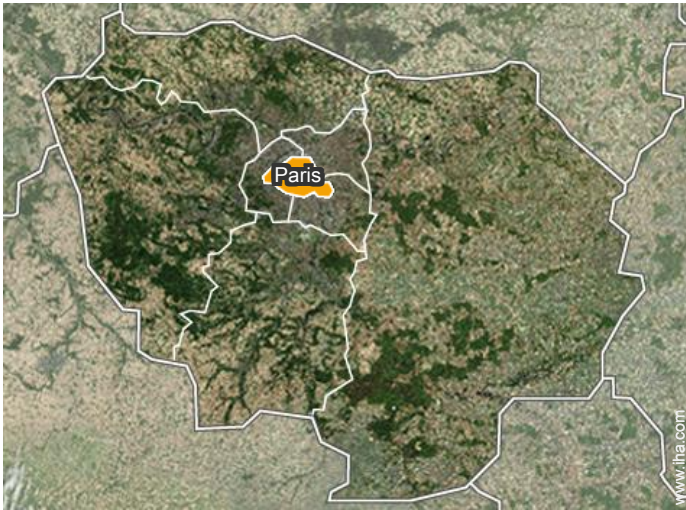

Gîte - Self Catering
Paris - Île de France
Studio Flat

Availability calendar - from : december 2017

| Dec | F | Sa | Su | M | Tu | W | Th | F | Sa | Su | M | Tu | W | Th | F | Sa | Su | M | Tu | W | Th | F | Sa | Su | | | | | | | |
|------|---|----|----|---|----|---|----|---|----|----|----|----|----|----|----|----|----|----|----|----|----|----|----|----|----|----|----|----|----|----|----|
| 2017 | 1 | 2 | 3 | 4 | 5 | 6 | 7 | 8 | 9 | 10 | 11 | 12 | 13 | 14 | 15 | 16 | 17 | 18 | 19 | 20 | 21 | 22 | 23 | 24 | 25 | 26 | 27 | 28 | 29 | 30 | 31 |
| | | | | | | | | | | | | | | | | | - | - | - | - | - | - | - | - | - | - | - | - | - | - | |

| Jan | M | Tu | W | Th | F | Sa | Su | M | Tu | W | Th | F | Sa | Su | M | Tu | W | Th | F | Sa | Su | M | Tu | W | | | | | | | |
|------|---|----|---|----|---|----|----|---|----|----|----|----|----|----|----|----|----|----|----|----|----|----|----|----|----|----|----|----|----|----|----|
| 2018 | 1 | 2 | 3 | 4 | 5 | 6 | 7 | 8 | 9 | 10 | 11 | 12 | 13 | 14 | 15 | 16 | 17 | 18 | 19 | 20 | 21 | 22 | 23 | 24 | 25 | 26 | 27 | 28 | 29 | 30 | 31 |
| | - | - | - | - | - | - | - | - | - | - | - | - | - | - | - | - | - | - | - | - | - | - | - | - | - | - | - | - | - | - | |

| Feb | Th | F | Sa | Su | M | Tu | W | Th | F | Sa | Su | M | Tu | W | Th | F | Sa | Su | M | Tu | W | | | | | | | | |
|------|----|---|----|----|---|----|---|----|---|----|----|----|----|----|----|----|----|----|----|----|----|----|----|----|----|----|----|----|---|
| 2018 | 1 | 2 | 3 | 4 | 5 | 6 | 7 | 8 | 9 | 10 | 11 | 12 | 13 | 14 | 15 | 16 | 17 | 18 | 19 | 20 | 21 | 22 | 23 | 24 | 25 | 26 | 27 | 28 | |
| | - | - | - | - | - | - | - | - | - | - | - | - | - | - | - | - | - | - | - | - | - | - | - | - | - | - | - | - | - |

| Mar | Th | F | Sa | Su | M | Tu | W | Th | F | Sa | Su | M | Tu | W | Th | F | Sa | Su | M | Tu | W | Th | F | Sa | | | | | | | |
|------|----|---|----|----|---|----|---|----|---|----|----|----|----|----|----|----|----|----|----|----|----|----|----|----|----|----|----|----|----|----|----|
| 2018 | 1 | 2 | 3 | 4 | 5 | 6 | 7 | 8 | 9 | 10 | 11 | 12 | 13 | 14 | 15 | 16 | 17 | 18 | 19 | 20 | 21 | 22 | 23 | 24 | 25 | 26 | 27 | 28 | 29 | 30 | 31 |
| | - | - | - | - | - | - | - | - | - | - | - | - | - | - | - | - | - | - | - | - | - | - | - | - | - | - | - | - | - | - | |

| Apr | Su | M | Tu | W | Th | F | Sa | Su | M | Tu | W | Th | F | Sa | Su | M | Tu | W | Th | F | Sa | Su | M | | | | | | | |
|------|----|---|----|---|----|---|----|----|---|----|----|----|----|----|----|----|----|----|----|----|----|----|----|----|----|----|----|----|----|----|
| 2018 | 1 | 2 | 3 | 4 | 5 | 6 | 7 | 8 | 9 | 10 | 11 | 12 | 13 | 14 | 15 | 16 | 17 | 18 | 19 | 20 | 21 | 22 | 23 | 24 | 25 | 26 | 27 | 28 | 29 | 30 |
| | - | - | - | - | - | - | - | - | - | - | - | - | - | - | - | - | - | - | - | - | - | - | - | - | - | - | - | - | - | - |

| May | Tu | W | Th | F | Sa | Su | M | Tu | W | Th | F | Sa | Su | M | Tu | W | Th | F | Sa | Su | M | Tu | W | Th | | | | | | | |
|------|----|---|----|---|----|----|---|----|---|----|----|----|----|----|----|----|----|----|----|----|----|----|----|----|----|----|----|----|----|----|----|
| 2018 | 1 | 2 | 3 | 4 | 5 | 6 | 7 | 8 | 9 | 10 | 11 | 12 | 13 | 14 | 15 | 16 | 17 | 18 | 19 | 20 | 21 | 22 | 23 | 24 | 25 | 26 | 27 | 28 | 29 | 30 | 31 |
| | - | - | - | - | - | - | - | - | - | - | - | - | - | - | - | - | - | - | - | - | - | - | - | - | - | - | - | - | - | - | |

| June | F | Sa | Su | M | Tu | W | Th | F | Sa | Su | M | Tu | W | Th | F | Sa | Su | M | Tu | W | Th | F | Sa | | | | | | | |
|------|---|----|----|---|----|---|----|---|----|----|----|----|----|----|----|----|----|----|----|----|----|----|----|----|----|----|----|----|----|----|
| 2018 | 1 | 2 | 3 | 4 | 5 | 6 | 7 | 8 | 9 | 10 | 11 | 12 | 13 | 14 | 15 | 16 | 17 | 18 | 19 | 20 | 21 | 22 | 23 | 24 | 25 | 26 | 27 | 28 | 29 | 30 |
| | - | - | - | - | - | - | - | - | - | - | - | - | - | - | - | - | - | - | - | - | - | - | - | - | - | - | - | - | - | - |

| Jul | Su | M | Tu | W | Th | F | Sa | Su | M | Tu | W | Th | F | Sa | Su | M | Tu | W | Th | F | Sa | Su | M | Tu | | | | | | | |
|------|----|---|----|---|----|---|----|----|---|----|----|----|----|----|----|----|----|----|----|----|----|----|----|----|----|----|----|----|----|----|----|
| 2018 | 1 | 2 | 3 | 4 | 5 | 6 | 7 | 8 | 9 | 10 | 11 | 12 | 13 | 14 | 15 | 16 | 17 | 18 | 19 | 20 | 21 | 22 | 23 | 24 | 25 | 26 | 27 | 28 | 29 | 30 | 31 |
| | - | - | - | - | - | - | - | - | - | - | - | - | - | - | - | - | - | - | - | - | - | - | - | - | - | - | - | - | - | - | |

| Aug | W | Th | F | Sa | Su | M | Tu | W | Th | F | Sa | Su | M | Tu | W | Th | F | Sa | Su | M | Tu | W | Th | F | | | | | | | |
|------|---|----|---|----|----|---|----|---|----|----|----|----|----|----|----|----|----|----|----|----|----|----|----|----|----|----|----|----|----|----|----|
| 2018 | 1 | 2 | 3 | 4 | 5 | 6 | 7 | 8 | 9 | 10 | 11 | 12 | 13 | 14 | 15 | 16 | 17 | 18 | 19 | 20 | 21 | 22 | 23 | 24 | 25 | 26 | 27 | 28 | 29 | 30 | 31 |
| | - | - | - | - | - | - | - | - | - | - | - | - | - | - | - | - | - | - | - | - | - | - | - | - | - | - | - | - | - | - | |

| Sep | Sa | Su | M | Tu | W | Th | F | Sa | Su | M | Tu | W | Th | F | Sa | Su | M | Tu | W | Th | F | Sa | Su | | | | | | | |
|------|----|----|---|----|---|----|---|----|----|----|----|----|----|----|----|----|----|----|----|----|----|----|----|----|----|----|----|----|----|----|
| 2018 | 1 | 2 | 3 | 4 | 5 | 6 | 7 | 8 | 9 | 10 | 11 | 12 | 13 | 14 | 15 | 16 | 17 | 18 | 19 | 20 | 21 | 22 | 23 | 24 | 25 | 26 | 27 | 28 | 29 | 30 |
| | - | - | - | - | - | - | - | - | - | - | - | - | - | - | - | - | - | - | - | - | - | - | - | - | - | - | - | - | - | - |

Gîte - Self Catering
Paris 7th district - France
Studio Flat

9

[Book now](#)

Availability calendar - from : september 2018

| Oct | M | Tu | W | Th | F | Sa | Su | M | Tu | W | Th | F | Sa | Su | M | Tu | W | Th | F | Sa | Su | M | Tu | W | |
|------|---|----|---|----|---|----|----|---|----|----|----|----|----|----|----|----|----|----|----|----|----|----|----|----|----|
| 2018 | 1 | 2 | 3 | 4 | 5 | 6 | 7 | 8 | 9 | 10 | 11 | 12 | 13 | 14 | 15 | 16 | 17 | 18 | 19 | 20 | 21 | 22 | 23 | 24 | 25 |

| Nov | Th | F | Sa | Su | M | Tu | W | Th | F | Sa | Su | M | Tu | W | Th | F | Sa | Su | M | Tu | W | Th | F | |
|------|----|---|----|----|---|----|---|----|---|----|----|----|----|----|----|----|----|----|----|----|----|----|----|----|
| 2018 | 1 | 2 | 3 | 4 | 5 | 6 | 7 | 8 | 9 | 10 | 11 | 12 | 13 | 14 | 15 | 16 | 17 | 18 | 19 | 20 | 21 | 22 | 23 | 24 |

[Month : Next >>](#)

Rental rates - Gîte - Self Catering - Studio Flat - from 1 to 3 Person(s)

| Rates | Night | Weekend | week | 2 weeks | Month |
|-------------------------------------------------------------------------------------------------|--------------|---------|--------|---------|---------|
|  Low season | \$68* > 2 | - | \$457* | \$880* | \$1583* |
|  Mid season | \$68* > 2 | - | - | - | - |
|  High season | \$68* > 2 | - | - | - | - |

> Minimum Night

[Book now](#)

Booking conditions

• Reservation

→ Payment made upon reservation : \$117*
→ Payment balance :
on handing over the keys

• rentals

→ Day tax included

Accepted methods of payment

• Visa/Delta/Electron • Bank transfer (wire) • MasterCard/EuroCard • Check • PayPal • Travellers Cheques

[▶ Book now](#)

[▶ Contact the owner](#)

Contact directly the property owners

www.iha.com

Advert No.

61396

[>> Book now <<](#)

Contact

Spoken languages



* Converted at the rate indicated : €100 = \$117.29 = £89.59

Advert No. 61396

www.iha.com

