

Vacation rental Le Cap d'Agde "Agde Marine II"

An exceptional view over the Harbour and the sea, with backdrop of fund the Pyrenees.



Apartment-Flat 9nd floor, shared entrance, in(on) a(an) Apartment house/ building 8 floors

Setting : nautical, exclusive

Capacity : from 1 to 4 person(s)

Bedroom(s) : 1

Room(s) : 2



Clé vacances (2 keys)

Le Cap d'Agde - Hérault (34) - Languedoc Roussillon
France

Reservation : +33 (0) 983804368 (France)

Advert No. 67422

www.ihaholiday.com



Vacation rental



Apartment-Flat 9nd floor, shared entrance, in(on) a(an) Apartment house/building 8 floors

- **Ideal for all age groups**
- **View :** panoramic, sea/ocean, harbour
- **Setting :** nautical, exclusive
- **Exposure :** South

" Located in the Center port of Cap d'Agde, with the main docks at the foot of the building. The beach is within walking distance (300 m) by the alley of loitering with all its shops. The restaurants and bars are on the docks. And in season, more, a garage in the basement. The tourist office is just opposite, at the end of the wharf. "

Assets

• Parking :

Covered parking : 1 closed individual place (s).



view of the port

Surroundings & location



" Cap d'Agde, you can go on the beach, water skiing, sailing, Board, scuba diving, beach volleyball, jet - skiing, motor boating, on his golf course 27 holes, tennis, horseback riding and naturally play on the many bowling balls. The hinterland is full of charm with Pézenas, the city of Molière and the wine plain with its many cellars. "

Leisure

• Leisure activities less than 12 miles :

Bathing, pedalo, snorkelling, scuba diving, banana boat, water skiing, jet ski, surfing, windsurfing, sailing, golf, tennis, squash, riding school, pony club, coastal/forest paths, mountain bike (path), parascending, boat trips, horse trekking, mini-golf, rollerblade/rollerskate (circuit), skate board (ramps), ATV/Quad Bike, go-karting, fishing, deep-sea fishing, fishing, spear fishing, pétanque field

• Supervised :

Sailing school, dive school, tennis school, riding school

• Attractions and relaxation :

Bar/pub, discotheque, restaurant, movie theater, leisure park, sea world, exhibition center, museum, festivals, local craftstore, cellar and wine tasting, casino, sauna, steam baths, health spa, beauticians, fitness center

Surroundings

• Locality :

Sea/ocean 990'
Sandy beach 990'
Nudist beach 0.62mi.
Sea inlet 0.3mi.
Public tennis court 0.5mi.
18 hole golf course 0.62mi.
Windsurfing spots 0.93mi.
Surfing spots 0.93mi.
Watersports centre 0.93mi.
Cliff 0.5mi.
Stretch of water 990'
Forest 0.93mi.
Marina 660'
Slipway 0.5mi.
Jetski slipway 0.93mi.

• Amenities :

Downtown 330'
Bus stop / bus station 660'
Bike/mountain bike hire 660'
Boat rental 990'
Scuba diving material hire 0.62mi.
Breadstore 660'
Caterer 330'
Local stores 660'
Supermarket 0.3mi.
Hairdressing salon 660'

Internet cafe <165'
Mail office <165'
Bank 330'
ATM 330'



Kitchen Area



living room



full bed(s)

Interior

- **Receive up to :**
from 1 to 4 person(s)
- **Liveable floor area :**
380 Sq.ft.
- **Interior layout :**
2 Room(s), 1 bedroom(s), 1 bathroom, 1 toilets, living room 172 Sq.ft., american style kitchen
- **Sleeps - bed(s) :**
1 full bed(s), 1 sleeper sofa(s) 2 pers
- **Guest facilities :**
T.V., board games, wifi, wardrobe, cupboard, Hanging wardrobe, hair dryer, fully air-conditioned, electric heating, Glazed in area, Blinds, entry phone system
- **Appliances :**
Crockery/flatware, kitchen utensils, electric coffee maker, electric kettle, toaster, juicer, electric hobs, mini-oven, micro-wave oven, extractor hood, refridgerator, dish washer, washing machine, vacuum cleaner, iron, ironing board

Exterior

- **Outside accommodation :**
Balcony 75 Sq.ft.

Services

- **washing :**
Comforter(s), Pillows
- **Single family home :**
Cleaning on departure supplement (+\$41*), Parking

For your guidance

- **For your guidance**
No kids under 4 years old
Pets accepted under certain conditions (ask the owner)
Cell phone network coverage
Water : hot/cold
Local voltage supply : 220-240V / 50Hz
Electricity supply : mains

Floor plan

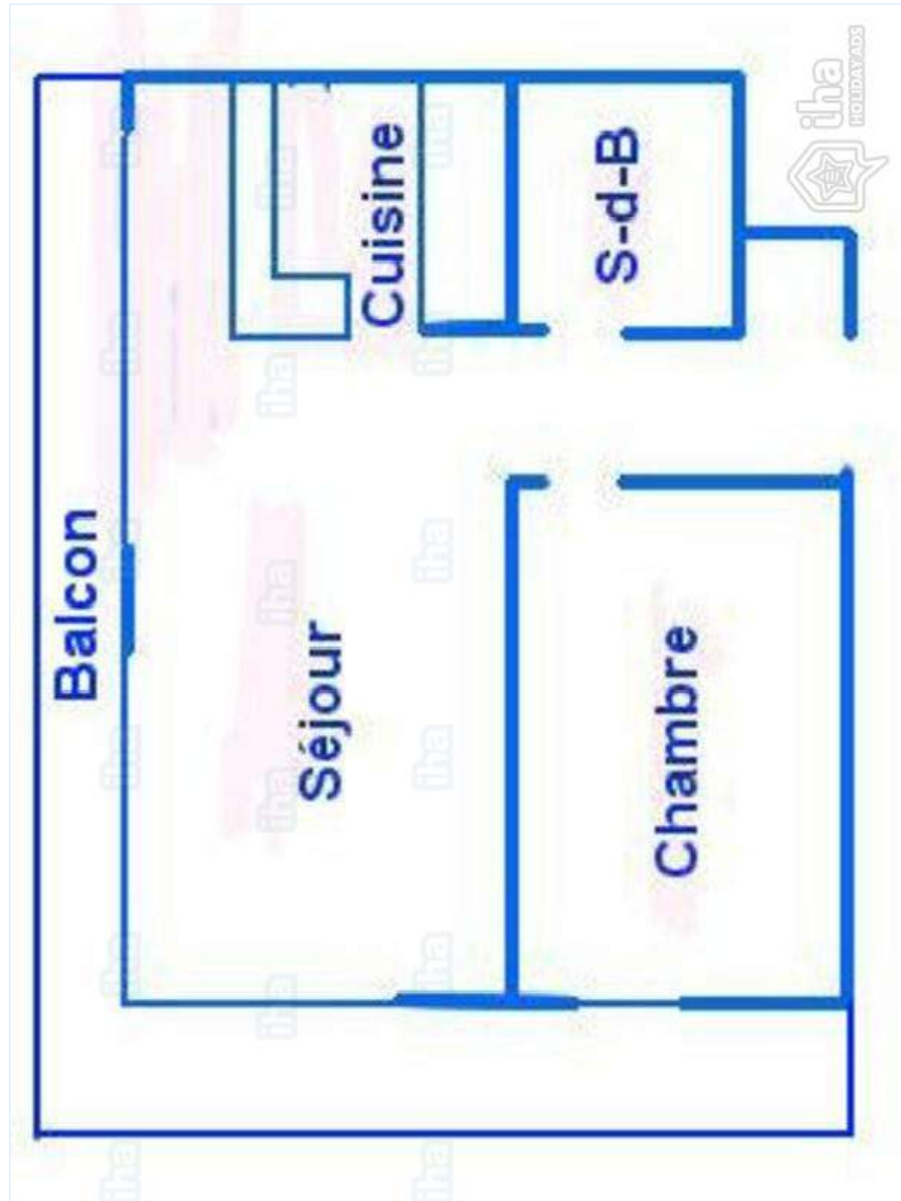

www.ih.com

Photo album - 1



view of the port



living room



Kitchen Area



full bed(s)

Location



Location & Access

" The apartment is located on the 8th floor and therefore enjoys an exceptional view of the sea and the port. It is located next to the post of Cap d'Agde and the administrative centre. "



GPS coordinates in degrees, minutes, seconds: Latitude 43°17'2"N - Longitude 3°30'50"E (Dwelling)

Address

→ 17 Place Agde Marine
Immeuble la Vigie
34300 Le Cap d'Agde

• Freeway (exit) A9

→ Agde, Hérault, Languedoc Roussillon,
France

→ Distance : 9mi.
→ Time : 15'

• Airport Béziers Cap d'Agde en Languedoc

→ Béziers, Hérault, Languedoc Roussillon,
France

→ Distance : 9mi.
→ Time : 20'

• Railroad station Agde

→ Agde, Hérault, Languedoc Roussillon,
France

→ Distance : 2.5mi.
→ Time : 15'

• Agde : (3mi.)

• Béziers : (15.5mi.)

• Montpellier : (40mi.)

Contact

Spoken
languages



Vacation rental Le Cap d'Agde - France "Agde Marine II"

7
[Book now](#)

Availability calendar - from : may 2019

May	W	Th	F	Sa	Su	M	Tu	W	Th	F	Sa	Su	M	Tu	W	Th	F	Sa	Su	M	Tu	W	Th	F	Sa	Su	M	Tu	W	Th	F	
2019	1	2	3	4	5	6	7	8	9	10	11	12	13	14	15	16	17	18	19	20	21	22	23	24	25	26	27	28	29	30	31	

June	Sa	Su	M	Tu	W	Th	F	Sa	Su	M	Tu	W	Th	F	Sa	Su	M	Tu	W	Th	F	Sa	Su	M	Tu	W	Th	F	Sa	Su
2019	1	2	3	4	5	6	7	8	9	10	11	12	13	14	15	16	17	18	19	20	21	22	23	24	25	26	27	28	29	30
	-	-	-	-	-	-	-	-	-	-	-	-	-	-	-	-	-	-	-	-	-	-	-	-	-	-	-	-	-	-

Jul	M	Tu	W	Th	F	Sa	Su	M	Tu	W	Th	F	Sa	Su	M	Tu	W	Th	F	Sa	Su	M	Tu	W	Th	F	Sa	Su	M	Tu	W
2019	1	2	3	4	5	6	7	8	9	10	11	12	13	14	15	16	17	18	19	20	21	22	23	24	25	26	27	28	29	30	31
	-	-	-	-	-	-	-	-	-	-	-	-	-	-	-	-	-	-	-	-	-	-	-	-	-	-	-	-	-	-	-

Aug	Th	F	Sa	Su	M	Tu	W	Th	F	Sa	Su	M	Tu	W	Th	F	Sa	Su	M	Tu	W	Th	F	Sa	Su	M	Tu	W	Th	F	Sa
2019	1	2	3	4	5	6	7	8	9	10	11	12	13	14	15	16	17	18	19	20	21	22	23	24	25	26	27	28	29	30	31
	-	-	-	-	-	-	-	-	-	-	-	-	-	-	-	-	-	-	-	-	-	-	-	-	-	-	-	-	-	-	-

Sep	Su	M	Tu	W	Th	F	Sa	Su	M	Tu	W	Th	F	Sa	Su	M	Tu	W	Th	F	Sa	Su	M	Tu	W	Th	F	Sa	Su	M
2019	1	2	3	4	5	6	7	8	9	10	11	12	13	14	15	16	17	18	19	20	21	22	23	24	25	26	27	28	29	30
	-	-	-	-	-	-	-	-	-	-	-	-	-	-	-	-	-	-	-	-	-	-	-	-	-	-	-	-	-	-

Oct	Tu	W	Th	F	Sa	Su	M	Tu	W	Th	F	Sa	Su	M	Tu	W	Th	F	Sa	Su	M	Tu	W	Th	F	Sa	Su	M	Tu	W	Th
2019	1	2	3	4	5	6	7	8	9	10	11	12	13	14	15	16	17	18	19	20	21	22	23	24	25	26	27	28	29	30	31
	-	-	-	-	-	-	-	-	-	-	-	-	-	-	-	-	-	-	-	-	-	-	-	-	-	-	-	-	-	-	-

Nov	F	Sa	Su	M	Tu	W	Th	F	Sa	Su	M	Tu	W	Th	F	Sa	Su	M	Tu	W	Th	F	Sa	Su	M	Tu	W	Th	F	Sa
2019	1	2	3	4	5	6	7	8	9	10	11	12	13	14	15	16	17	18	19	20	21	22	23	24	25	26	27	28	29	30
	-	-	-	-	-	-	-	-	-	-	-	-	-	-	-	-	-	-	-	-	-	-	-	-	-	-	-	-	-	-

Dec	Su	M	Tu	W	Th	F	Sa	Su	M	Tu	W	Th	F	Sa	Su	M	Tu	W	Th	F	Sa	Su	M	Tu	W	Th	F	Sa	Su	M	Tu
2019	1	2	3	4	5	6	7	8	9	10	11	12	13	14	15	16	17	18	19	20	21	22	23	24	25	26	27	28	29	30	31
	-	-	-	-	-	-	-	-	-	-	-	-	-	-	-	-	-	-	-	-	-	-	-	-	-	-	-	-	-	-	-

Jan	W	Th	F	Sa	Su	M	Tu	W	Th	F	Sa	Su	M	Tu	W	Th	F	Sa	Su	M	Tu	W	Th	F	Sa	Su	M	Tu	W	Th	F
2020	1	2	3	4	5	6	7	8	9	10	11	12	13	14	15	16	17	18	19	20	21	22	23	24	25	26	27	28	29	30	31
	-	-	-	-	-	-	-	-	-	-	-	-	-	-	-	-	-	-	-	-	-	-	-	-	-	-	-	-	-	-	-

Feb	Sa	Su	M	Tu	W	Th	F	Sa	Su	M	Tu	W	Th	F	Sa	Su	M	Tu	W	Th	F	Sa							
2020	1	2	3	4	5	6	7	8	9	10	11	12	13	14	15	16	17	18	19	20	21	22	23	24	25	26	27	28	29
	-	-	-	-	-	-	-	-	-	-	-	-	-	-	-	-	-	-	-	-	-	-	-	-	-	-	-	-	-

Promotional period
 Mid season
 High season
 Low season

Vacation rental
Hérault - Languedoc Roussillon
"Agde Marine II"

8
[Book now](#)

Availability calendar - from : february 2020

Mar	Su	M	Tu	W	Th	F	Sa	Su	M	Tu	W	Th	F	Sa	Su	M	Tu	W	Th	F	Sa	Su	M	Tu							
2020	1	2	3	4	5	6	7	8	9	10	11	12	13	14	15	16	17	18	19	20	21	22	23	24	25	26	27	28	29	30	31
-	-	-	-	-	-	-	-	-	-	-	-	-	-	-	-	-	-	-	-	-	-	-	-	-	-	-	-	-	-	-	

Apr	W	Th	F	Sa	Su	M	Tu	W	Th	F	Sa	Su	M	Tu	W	Th	F	Sa	Su	M	Tu	W	Th							
2020	1	2	3	4	5	6	7	8	9	10	11	12	13	14	15	16	17	18	19	20	21	22	23	24	25	26	27	28	29	30
-	-	-	-	-	-	-	-	-	-	-	-	-	-	-	-	-	-	-	-	-	-	-	-	-	-	-	-	-	-	

Promotional period Mid season High season Low season

[Month : Next >>](#)

Rental rates - Apartment-Flat - from 1 to 4 Person(s)

Rates	Night	Weekend	week	2 weeks	Month
Low season	-	-	\$386* (Saturday)	-	-
Mid season	-	-	\$619* (Saturday)	-	-
High season	-	-	\$736* (Saturday)	-	-
Promotional period	-	-	\$315* (Saturday)	-	-

(Check-in day)

[Book now](#)

Booking conditions

• Reservation

- Payment made upon reservation : 30% of rental sum
- Payment balance : on handing over the keys
- Deposit required : \$292*

• rentals

- Service charges included
- Day tax in addition

Accepted methods of payment

- Bank transfer (wire) • Check • Cash

[▶ Book now](#)

[▶ Contact the owner](#)

Contact directly the property owners

www.iha.com
Advert No.
67422
[>> Book now <<](#)

Contact

Spoken languages



* Converted at the rate indicated : €100 = \$116.85 = £89

Advert No. 67422

www.iha.com

