

Vacation rental Waitakere "Flaxmere House"

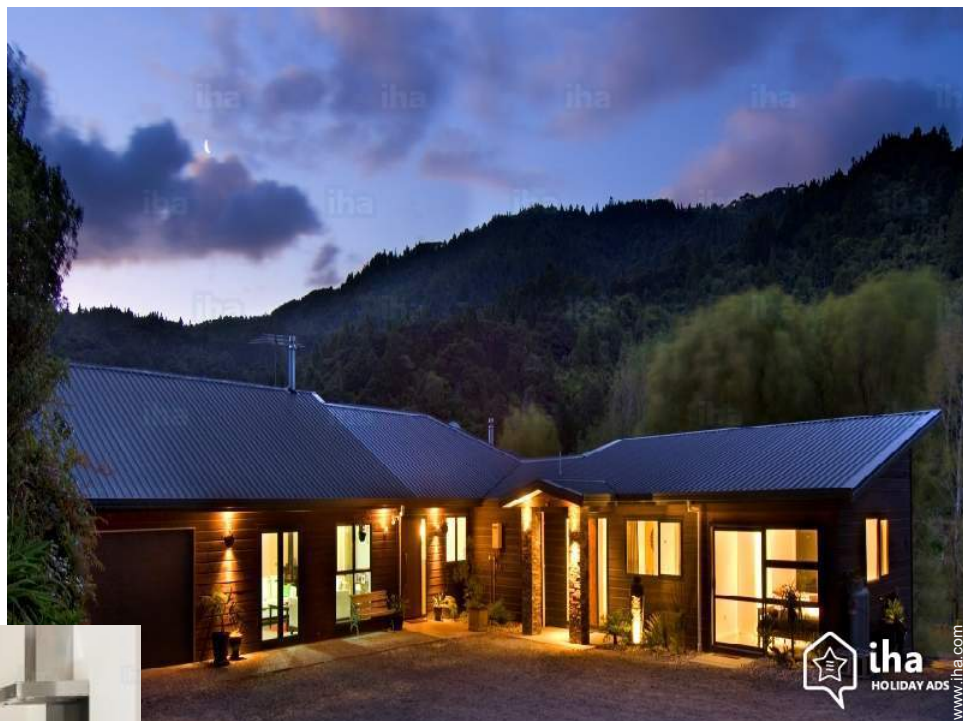

House, detached, 1 floor, separate entrance, in(on) a(an) Estate

Setting : rural, tranquil

Capacity : from 4 to 20 person(s)

Bedroom(s) : 8

Room(s) : 13



Family Holiday Destinations ()

Waitakere - Auckland Region - North Island
New Zealand

Reservation : +64 (0) 98108188 (New Zealand)

Advert No. 44999

www.iha.com



>> VACATION HOMES

DIRECT BY OWNERS

Vacation rental



House, detached, 1 floor, separate entrance, in(on) a(an) Estate

- **Ideal for all age groups, family groups**

- **View :** country side, farmland, forest, fantastic sunset
- **Setting :** rural, tranquil
- **Exposure :** North

Assets

- **Parking :**
Parking uncovered : 12 internal.
- **Advantages :**
Jacuzzi

Surroundings & location



Countryside Golf Horse riding Fishing



Spa

Leisure

- **Leisure activities less than 12 miles :**
Golf, coastal/forest paths, horse trekking, skate board (ramps), go-karting
- **Supervised :**
Riding school

Surroundings

- **Locality :**
Sandy beach
Rocky beach
18 hole golf course
Waterfall
Lake
Forest



interior



bedroom



Interior

- **Receive up to :**
from 4 to 20 person(s) (16 adults, 4 kids)
- **Liveable floor area :**
4,850 Sq.ft.
- **Interior layout :**
13 Room(s), 8 bedroom(s), 3 bathroom, 3 shower room, 3 toilets, living room 430 Sq. ft., sitting room 970 Sq.ft., Kitchen Area, dining room, dining area, dance room, walk-in closet, reception hall, laundry room, pantry, patio
- **Sleeps - bed(s) :**
4 queen-size bed(s), 2 king-size bed(s), 2 foldaway bed(s) 2 pers, 1 sleeper sofa(s) 2 pers, 2 twin bed(s), 5 possible extra bed(s)
- **Guest facilities :**
Fireplace, T.V., digital home cinema, DVD player, phone, internet access, wifi, wardrobe, cupboard, hair dryer, heated towel rail, ceiling paddle fan, Drapes, Double glazed
- **Appliances :**
Crockery/flatware, kitchen utensils, electric espresso coffee maker, electric kettle, toaster, food processor, gaz stove, electric stove, electric hobs, mini-oven, micro-wave oven, electric fries fryer, extractor hood, refridgerator, dish washer, washing machine, vacuum cleaner, iron, ironing board

Exterior

- **Ground surface :**
4,300 Sq.ft.
- **Outside accommodation :**
Covered terrace 970 Sq.ft., gazebo
- **Outside setting :**
Private courtyard, landscaped yard, lawn, river
- **Outside amenities :**
BBQ, yard table(s), yard seated area

Services

- **washing :**
Sheets (1 X / per week), Towels (1 X / per week), Linen (3 X / per week), Beach towels (2 X / per week), Comforter(s) (1 X / per week), Pillows (1 X / per week)
- **Single family home :**
Cleaning (1 X / per week), Cleaning on departure, Yard/swimming pool maintenance
- **Personnel :**
Staff, Chef(s), Laundry, Beauty treatments, Massage
- **Restauration :**
Breakfast, BBQ meal

For your guidance

- **For your guidance**
Kids welcome
Pets accepted under certain conditions (ask the owner)
Water : hot/cold
Electricity supply : mains
- **Handicapped people welcome**
Wheelchair access
Fitted out for the disabled : mobility

Floor plan

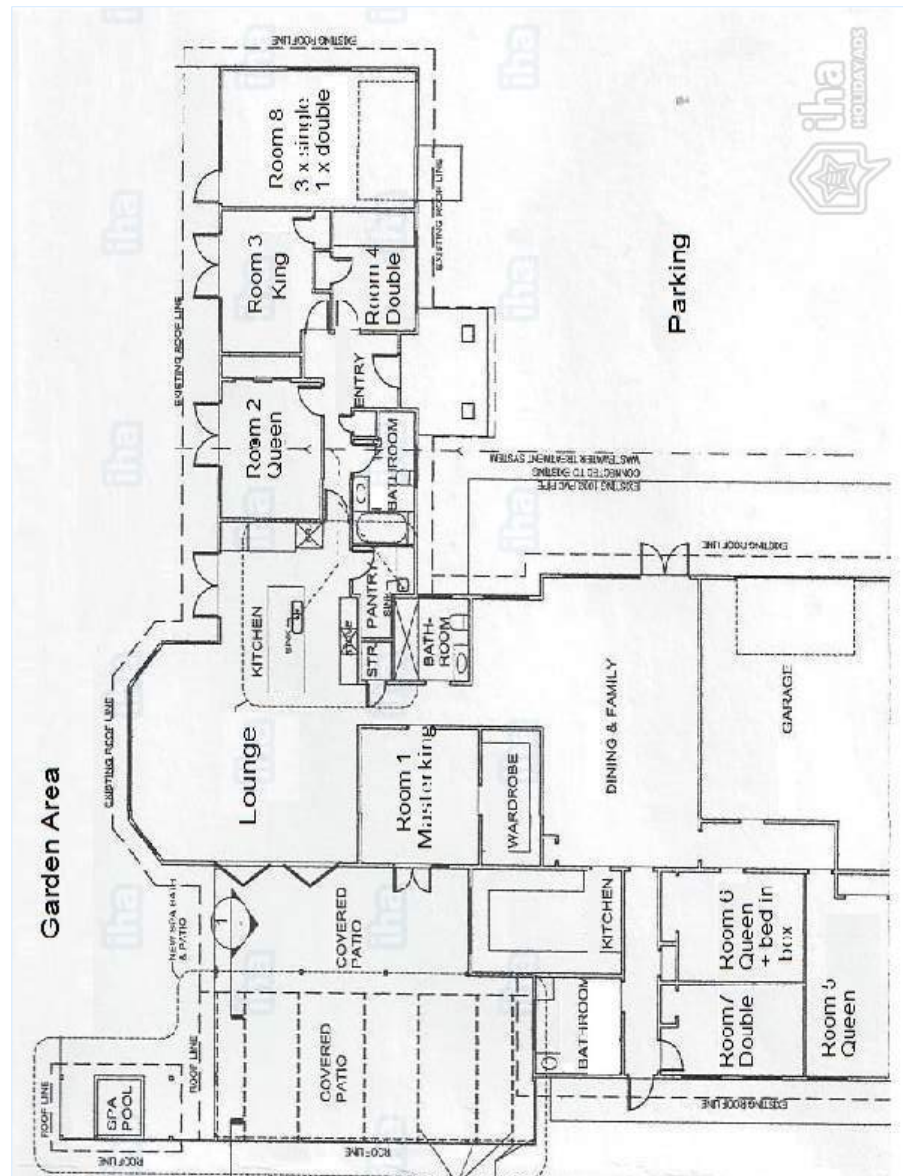

Vacation rental
Auckland Region - Waitakere
"Flaxmere House"

5
[Book now](#)

Photo album - 1



interior



bedroom



Location



Location & Access



GPS coordinates in degrees, minutes, seconds: Latitude 36°52'3"S - Longitude 174°29'6"E ([Dwelling](#))

Address

→ 129 Bethells Road
1008 Waitakere

• Airport Auckland

→ Auckland City, Auckland Region, North Island, New Zealand
→ Distance : 27,5mi.

- Waitakere : (3mi.)
- Auckland City : (20mi.)
- Kumeu : (10mi.)

Contact

Spoken languages



Vacation rental
Waitakere - New Zealand
"Flaxmere House"

7
[Book now](#)

Rental rates - House - from 4 to 20 Person(s)

Rates	Night	Weekend	week	2 weeks	Month
 High season	\$877* (Monday) > 2	\$1097* (Friday)	\$5849* (Friday)	\$10235* (Friday)	-
(Check-in day)	> Minimum Night				

[Book now](#)



interior

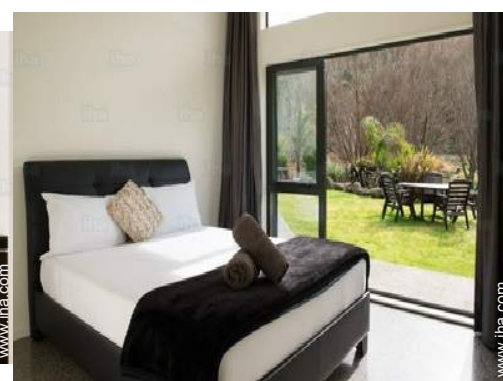

bedroom

Booking conditions

• Reservation

→ Payment made upon reservation :
30% of rental sum
→ Payment balance :
1 month before the stay

• rentals

→ Service charges to be added
→ Day tax in addition
→ Cleaning charge levy on departure :
\$219*

[▶ Book now](#)

[▶ Contact the owner](#)

Accepted methods of payment

• Visa/Delta/Electron • Bank transfer
(wire) • MasterCard/EuroCard • Cash

Contact directly the property owners

www.iha.com
Advert No.
44999
[>> Book now <<](#)

Contact

Spoken
languages



* Converted at the rate indicated : €100 = \$123.46 = £88.94

Advert No. 44999

www.iha.com

